

Prefabricated Data Center

FusionModule1000A All-in-One Prefabricated Data Center

Introduction

Huawei FusionModule1000A is an advanced outdoor and prefabricated all-in-one data center facility solution. The solution provides reliable, stable and green environment for IT equipment. The solution can be applied to multiple industries and scenarios and meet data center's requirements on energy saving and fast deployment.

Applicable Industry and Scenario

Enterprise: small data center

Government: data center of smart city and safe city

Education: data center of university and science institute

Energy: on-site data center of mining and exploration

Finance: backup data center

Transportation: power supply for non-IT room of airport/railway station/port

Telecom carrier: small IT room, small IDC, DR equipment room



FusionModule1000A 20ft

Features & Value

Simple

- Enclosure, power, cooling, firefighting and DCIM system are prefabricated. All facilities are pre-installed and pre-tested before delivery. It minimizes the engineering work and the on-site installation only takes one day.
- Moveable design make relocation easy and deployment flexibly.

Efficient

- High-efficiency UPS, air-cooled in-row PAC, aisle containment, enclosure of low heat transfer coefficient, industry-leading PUE
- Huawei NetEco system (optional) centralize the management of multiple sites.

Reliable

- IP55 protection and 9-degree anti-seismic
- Durable enclosure, multiple access control and video surveillance protect the asset

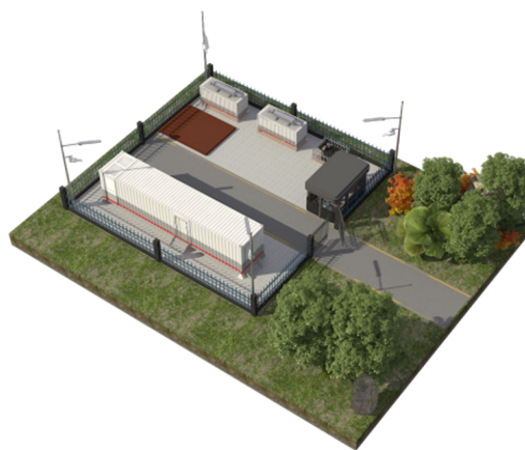

FusionModule1000A Site Scenery

Layout

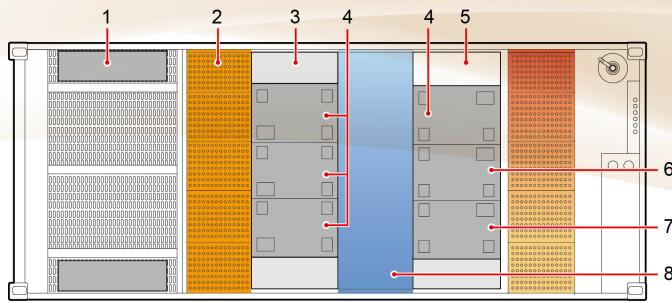

- ① A/C outdoor uni ② Hot aisle ③ A/C indoor unit ④ IT cabinet
- ⑤ Tool cabinet ⑥ UPS cabinet ⑦ Battery cabinet ⑧ Cold aisle

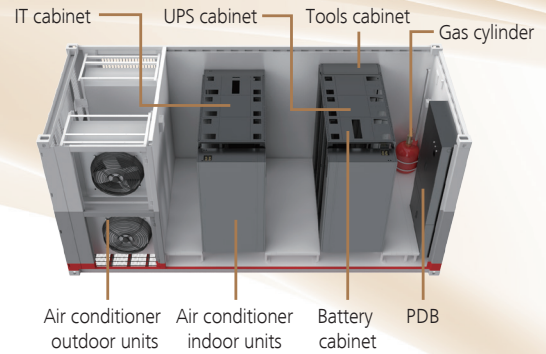

FusionModule1000A 20ft

Specifications

	Sub-item	FusionModule1000A 20ft 380V
Power	Total IT load	≤ 24kW
	Power density per rack	≤ 6kW
	Input mode	2x160A, 50/60Hz, 3Ph+N+PE,380V/400V/415V AC
	UPS model	Rack-mounted 20kVA UPS
	UPS capacity	≤ 40KVA (2+1 redundancy)
	BAT backup time ^①	≥10min
	Number of input	2 inputs
Rack	Rack capacity ^③	4 × 45U IT rack
	Rack Distribution	4 × 6kW/rack
	Triple-rack size (H × W × D)	2100mm × 1650mm × 1000mm
Cooling	A/C type	Air-cooled in-row PAC
	Sensible cooling capacity	20kW/unit (2+1 redundancy)
	Coolant	R410A
	A/C group control	Support
	Temp. range	18~27°C
	Humidity range	20%~80%
	Hot/cold aisle	Hot aisle containment
Humidification	Electrode humidifier	

	Sub-item	FusionModule1000A 20ft 380V
Fire protection	Auto fire protection system	Automatic fire detection & suppression system c/w emergency release function
	Alarm	Automatic monitoring and detection, support sound and light alarm
	Gas	Standard HFC-227ea, (Customerization: NOVEC1230)
Monitoring	Module access	IC card reader as default optional three-in-one access control
	Monitoring management	Real-time monitoring of temperature and humidity control, fire control, access control and cooling system
Enclosure	External size (H × W × D)	2896mm × 2438mm × 6058mm
	Aisle width	Cold aisle: 890mm Hot aisle: ≤ 610mm
Protection	Dustproof and waterproof	IP55
	Anti-seismic	ETSI EN 300 019-2-4 (equal to mercail intensity 9)
Operating Environment	Operating humidity (RH)	5% ~ 100%
	Operating temp ^④	-15°C ~ +52°C
	Altitude ^⑤	≤ 3000m

① ③: The BAT backup time and rack capacity vary in configuration. Details refer to the Product Overview .

②: Surge protection level vary in configuration. Details refer to the Product Overview

④: Low-temperature air-conditioner is required for -40°C to -20°C.

⑤: Output power derating is required when the altitude is over 1000m.

Copyright © Huawei Technologies Co., Ltd. 2018. All rights reserved.

No part of this document may be reproduced or transmitted in any form or by any means without prior written consent of Huawei Technologies Co., Ltd.

General Disclaimer

The information in this document may contain predictive statements including, without limitation, statements regarding the future financial and operating results, future product portfolio, new technology, etc. There are a number of factors that could cause actual results and developments to differ materially from those expressed or implied in the predictive statements. Therefore, such information is provided for reference purpose only and constitutes neither an offer nor an acceptance. Huawei may change the information at any time without notice.

HUAWEI TECHNOLOGIES CO., LTD.

Huawei Industrial Base
Bantian Longgang
Shenzhen 518129, P.R. China
Tel: +86-755-28780808

www.huawei.com